

# Electric solenoid bolts

## Adams Rite 1391

### Application:

The Adams Rite 1391 Electric Solenoid Bolt is used to facilitate the remote access and exit control of aluminium, timber or steel doors.

### Specification:

<ul style="list-style-type: none"><li>• Suitable for use on aluminium, timber and steel doors</li><li>• Holding force in excess of 1000kg</li><li>• Slimline style allows the lock to be concealed fitted into the door frame</li><li>• CE marked to EMC Directive</li><li>• Stainless steel deadbolt has a 16mm throw</li></ul>	<ul style="list-style-type: none"><li>• Suitable for single and double action doors (with positive centring door closers)</li><li>• Can be fitted into head or into vertical locking stile</li><li>• Surface box available with glass door brackets</li></ul>
--	---

### Finish:

1391 Surface Box ~ RiteKey Keypad ~ Push-to-Exit Button  
~ Power Supply Unit

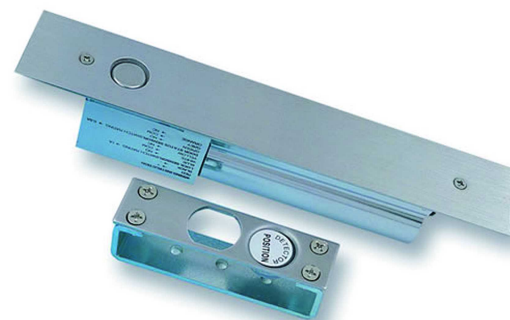

### Standards:

Solenoid Lock:	38mm x 210mm x 43mm.
Cover Plate:	38mm x 220mm x 1mm.
Cover Plate Finish:	Brushed stainless steel
Strike Plate:	24mm x 90mm (27mm deep for metal doors).
Strike Plate Finish:	Brushed stainless steel
Nominal Current Draw:	@12vDC locking motion 0.9A maintained locked position 0.3A. @24vDC locking motion 0.5A maintained locked position 0.15A. Voltage tolerance $\pm 15\%$ .
Solenoid:	Continuous duty.
Duty:	Fail safe.
Time Delay:	0, 2.5 or 5 secs. User selectable
Monitoring:	Door status and lock sensors.
Bolt Throw:	16mm
Door Gap:	Recommended 3mm
Installation:	Horizontal or vertical mounting.
Note:	To achieve immediate release, it is important that the release switch breaks the circuit on the positive supply to the solenoid bolt.

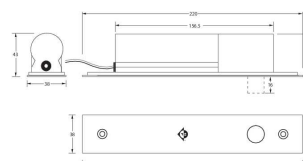

# Electric solenoid bolts

## Adams Rite 1391

### Variants:

Code	Description
1391-1042	1391 SOLENOID BOLT 12VDC FAIL SAFE C/W ARMATURE PLATE
1391-2042	1391 SOLENOID BOLT 24VDC FAIL SAFE C/W ARMATURE PLATE
1391-3042	1391 SURFACE MOUNT BOX BRUSHED STAINLESS STEEL FINISH